

REMOVAL

1. INSPECT SHOE LINING THICKNESS

Remove the inspection hole plug, and check the shoe lining thickness through the hole.

If it is less than minimum, replace the shoes.

Minimum thickness: 1.0 mm (0.039 in.)

2. REMOVE REAR WHEEL

Torque: 103 N·m (1,050 kgf·cm, 76 ft·lbf)

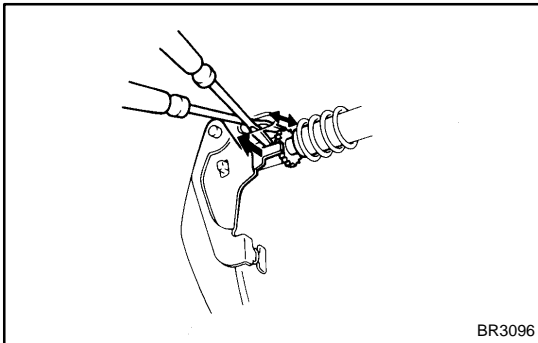

3. REMOVE BRAKE DRUM

- (a) Release the parking brake lever and remove the brake drum.

HINT:

If the brake drum cannot be removed easily, do the following steps.

- (b) Remove the adjusting hole plug in the backing plate.
 (c) Insert a screwdriver through the hole in the backing plate, and hold the automatic adjusting lever away from the adjusting bolt.
 (d) Using another screwdriver, reduce the brake shoe adjustment by turning the adjusting bolt.

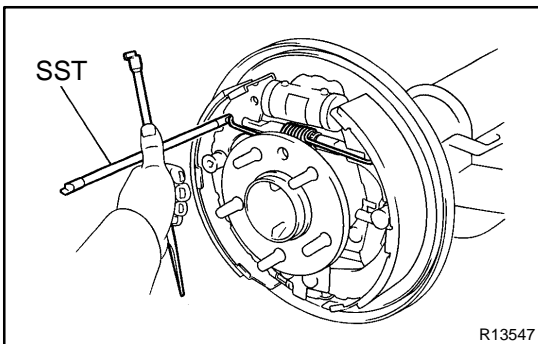

4. REMOVE FRONT SHOE

- (a) Using SST, disconnect the return spring.
 SST 09703-30010

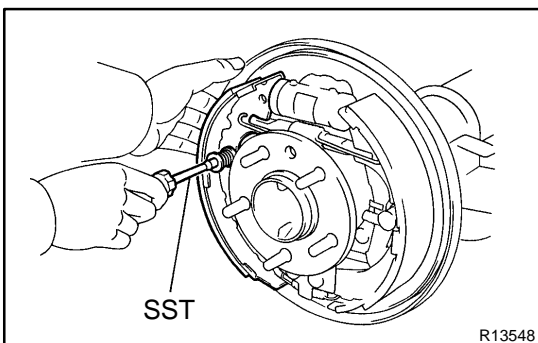

- (b) Using SST, remove the shoe hold-down spring, 2 cups and pin.
 SST 09718-00010
 (c) Disconnect the anchor spring from the front shoe and remove the front shoe.
 (d) Remove the anchor spring from the rear shoe.

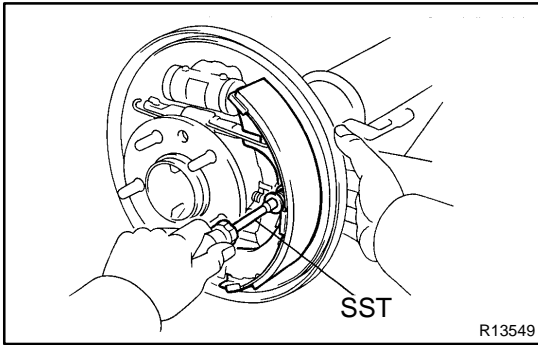
**5. REMOVE ADJUSTER AND REAR SHOE**

- (a) Using SST, remove the shoe hold-down spring, 2 cups and pin.
SST 09718-00010
- (b) Remove the adjusting lever spring.
- (c) Remove the adjuster together with the return spring.
- (d) Using pliers, disconnect the parking brake cable from the lever and remove the rear shoe.

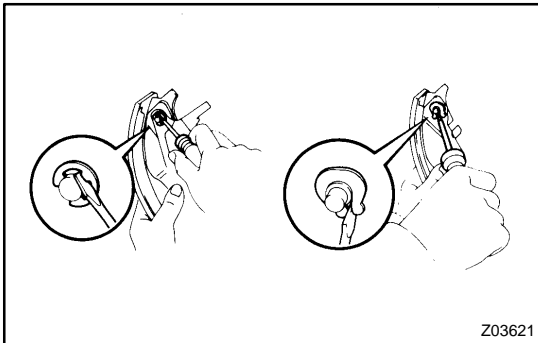
**6. REMOVE AUTOMATIC ADJUSTING LEVER AND PARKING BRAKE LEVER**

- (a) Remove the E-ring.
- (b) Remove the automatic adjusting lever.
- (c) Remove the C-washer.
- (d) Remove the parking brake lever.

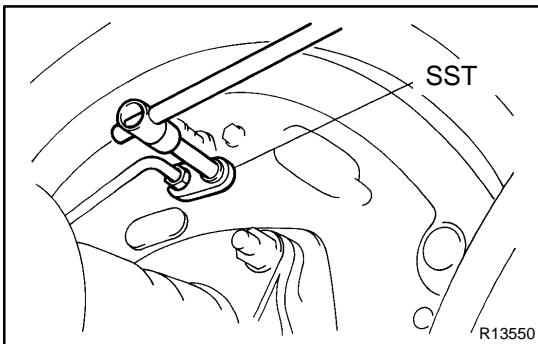
**7. DISCONNECT BRAKE LINE FROM WHEEL CYLINDER**

Using SST, disconnect the brake line. Use a container to catch the brake fluid.

SST 09023-00100

Torque: 15 N·m (155 kgf·cm, 11 ft·lbf)

8. REMOVE WHEEL CYLINDER

Remove the 2 bolts and wheel cylinder.

Torque: 10 N·m (100 kgf·cm, 7 ft·lbf)

9. DISASSEMBLE WHEEL CYLINDER

- (a) Remove the 2 boots, 2 pistons and spring.
- (b) Remove the 2 piston cups from each piston.